

ECA Workshop 2010

9 June 2010, Graz, Austria

University of Graz, Meerscheinschlößl (Festsaal),
Mozartgasse 3

Programme

13:00-14:00	Lunch
14:00-15:00	WG meetings in RESOWI B (<i>see maps below</i>)
	WG 1: B2 SR 15.21
	WG 4: B3 SR 15.33
15:00-16:00	ECA Business Meeting
16:00-17:10	Presentations WG 1 & WG 2
17:10-17:40	<i>Coffee break</i>
17:40-18:50	Presentations WG 3 & WG 4
18:50-19:00	Conclusions

19.00 Walk to restaurant [Aiola upstairs](#) (*luggage will be taken to hotel by hosts*)

Directions

To Hotel Gollner



Hotel Gollner
Schlögeltgasse 14
www.hotelgollner.at
+43 316 82 25 21-0

From the airport

By bus

The bus lines 630 and 631 leave right in front of the airport. They reach Graz city centre (*Jakominiplatz*) within 20 minutes. Single tickets are 1,90 € (ticket is valid for one hour in public transport throughout Graz). They can be purchased at vending machines at the airport or in the bus. The buses leave generally twice an hour.

[TIME TABLE BUS](#)

From *Jakominiplatz* to Hotel Gollner you can either take tramway 6 (direction *St. Peter*) and get off at *Dietrichsteinplatz* or you walk to the hotel (350 metres).

By train

The suburban train S5 connects the airport (*Flughafen*) to Graz main station (*Graz Hbf*). S5 trains leave generally once an hour, but more often during rush hour. It takes 11 minutes and the ticket costs 1,90 € (ticket is valid for one hour in public transport throughout Graz).

[TIME TABLE TRAIN](#)

From Graz main station to Hotel Gollner take tram 6 (direction *St. Peter*) and get off at *Dietrichsteinplatz*.

By taxi

Taxis are found outside the terminal. A journey to the city centre is about 30 € and will take 15 to 20 minutes.

From Graz main station

From Graz main station to Hotel Gollner take tram 6 (direction *St. Peter*) and get off at *Dietrichsteinplatz*.

To ECA Workshop Venue (Meerscheinschlößl)



Meerscheinschlößl
Mozartgasse 3

From the airport

By bus

The bus lines 630 and 631 leave right in front of the airport. They reach Graz city centre (*Jakominiplatz*) within 20 minutes. Single tickets are 1,90 € (ticket is valid for one hour in public transport throughout Graz). They can be purchased at vending machines at the airport or in the bus. The buses leave generally twice an hour.

[TIME TABLE BUS](#)

From *Jakominiplatz* to the workshop venue you can either take bus 30 (direction *Geidorf*) and get off at *Mozartgasse* or bus 39 (direction *Uni/RESOWI*) and get off at *Uni/Mensa* and walk some 500 metres to Meerscheinschlößl.

ECA Workshop 2010, Graz

By train

The suburban train S5 connects the airport (*Flughafen*) to Graz main station (*Graz Hbf*). S5 trains leave generally once an hour, but more often during rush hour. It takes 11 minutes and the ticket costs 1,90 € (ticket is valid for one hour in public transport throughout Graz).

[TIME TABLE TRAIN](#)

From Graz main station to the workshop venue you can either take bus 58 (direction *Mariagrün*) and get off at *Mozartgasse* or bus 63 (direction *Petersbergenstraße*) and get off at *Attemsgasse* and walk some 500 metres to Meerscheinschlößl.

From Graz main station

From Graz main station to the workshop venue you can either take bus 58 (direction *Mariagrün*) and get off at *Mozartgasse* or bus 63 (direction *Petersbergenstraße*) and get off at *Attemsgasse* and walk some 500 metres to Meerscheinschlößl.

From Hotel Gollner

From Hotel Gollner to the workshop venue you can either take bus 30 (direction *Geidorf*) starting at *Kaiser-Josef-Platz/Oper* and get off at *Mozartgasse* or bus 39 (direction *Uni/RESOWI*) and get off at *Uni/Mensa* and walk some 500 metres to Meerscheinschlößl.



Bus stops around the university

From Workshop venue to Working Group meetings (From Meerscheinschlößl to RESOWI-Zentrum)



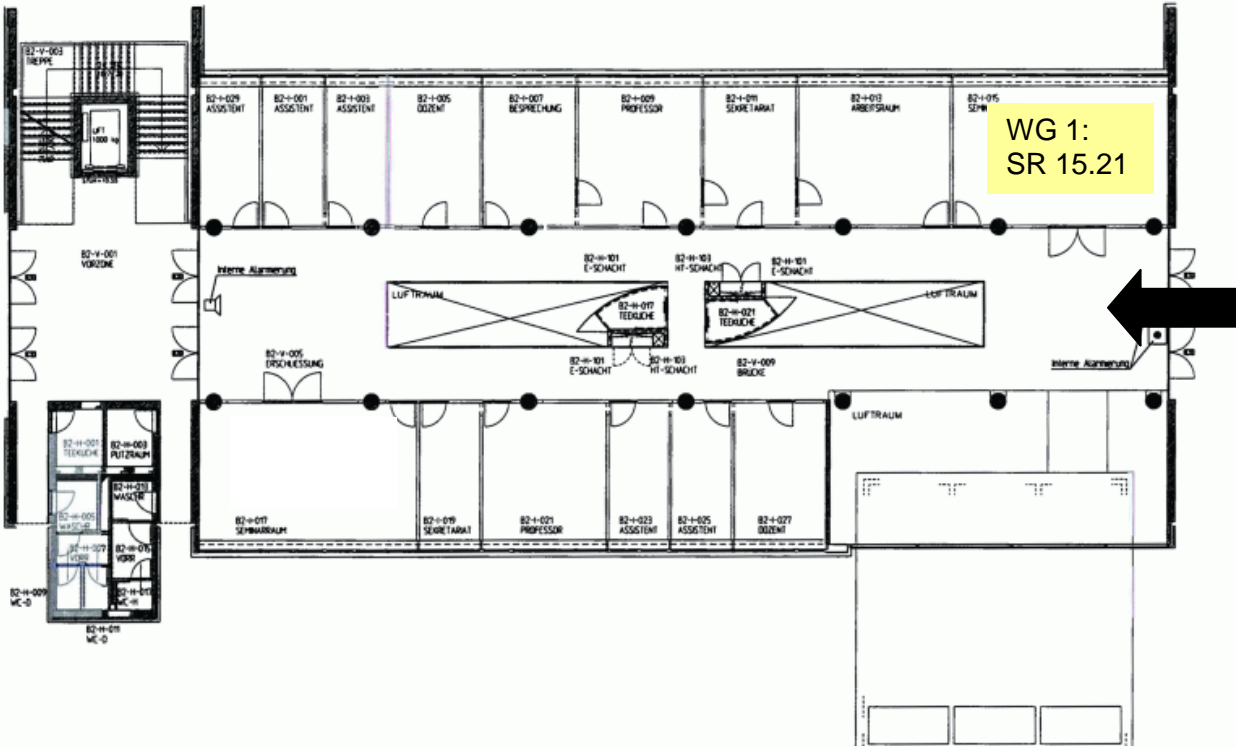

Working Group meetings
 WG 1
 RESOWI UNIT B2
 2nd floor
 SR 15.21

Working Group meeting
 WG 4
 RESOWI UNIT B2
 3rd floor
 SR 15.33

